



Hands-on! Code Handle®

ASSA ABLOY
Opening Solutions

4 digits separate your private or sensitive stuff from public access

You don't have eyes in the back of your head. It's impossible to keep watch over every private door in a public-facing space — the store room in a retail shop or pharmacy, or a toilet for staff use only. That's when you need Code Handle: it stands guard for you. With Code Handle, personal belongings, sensitive client files or storage materials are separated easily from public areas.



Keyless and convenient

Secure your private rooms with no keys, no wires and no expensive access control system. It's simple with Code Handle.



Easy to install and retrofit

All it takes is two screws to fit a Code Handle on almost any interior door. You'll receive a master code and up to 9 different user PINs.



Autolock

How frequently do you need to enter and leave the store room? No more needing to remember to lock the door. Be key-free. If you like, even handsfree.



Application

Code Handle helps to control private access in public spaces, like archives, stock rooms, guest toilets, medical storage or offices.

Experience a safer
and more open world

Code Handle technical data

For European DIN standard lock cases
Suitable for commercial and residential applications

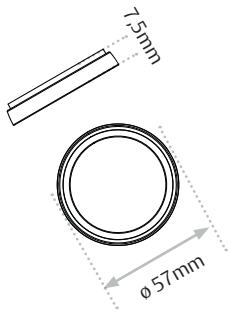

Distance ring
available to adjust the
rosette to the door

Code Handle is delivered as a set of 2 handles, one with the PIN code function, the other without*. Please consider door direction for correct ordering.

* Non-coded handle model also available.

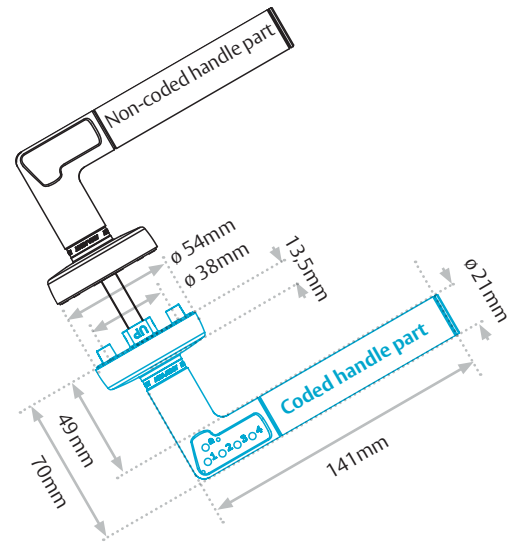

Euro Version: DIN Standard Model 8812

Door directions with left handle version:

The handle with the PIN code function points to « the left »

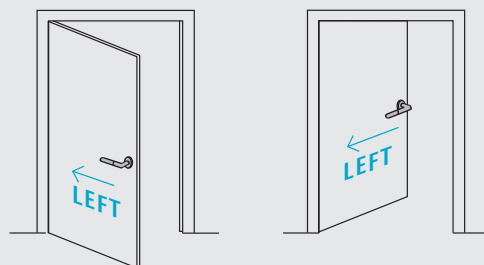
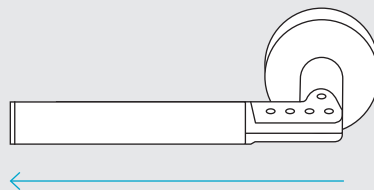

Door directions with right handle version:

The handle with the PIN code function points to « the right »

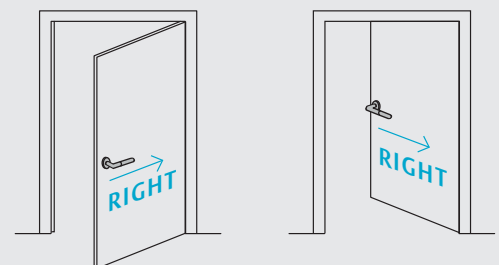
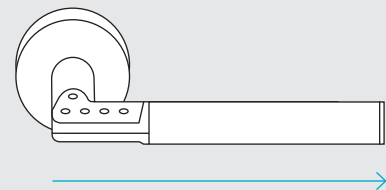

Installation:
It's so easy –
2 screws is all you need.
Check our video:
youtu.be/ylyvOCixLvw

Code Handle technical data and features

| | |
|--------------------------|---|
| Power supply | 2 × lithium-ion batteries 3 V (CR2); > 30,000 cycles life |
| Functionalities | Auto-lock; Permanent unlocked |
| Codes | 9 user codes (4 – 6 digits), 1 master code (6 digits) |
| Signals | Visual: LED display (green, red); Acoustic: adjustable on/off |
| Door requirements | Interior doors |
| Door types | European DIN standard (8812) |
| Spindle | 8mm |
| Door thickness | Suitable for 35 – 80mm |
| Fire tested | According to EN 1634 |
| Handle | L-shape |
| Surface | Zinc-diecasting and stainless steel |

ASSA ABLOY Opening Solutions UK & Ireland
Door Hardware Group
School Street
Willenhall
West Midlands
WV13 3PW

+44 (0)845 223 2124
csdcomm@assaabloy.com

www.assaabloyopeningsolutions.co.uk/codehandle