

CONTROL UNIT AS A TRANSMITTER

Evacuation /Siren System

Control Unit Channel	Wireless Smoke Alarm Channel	Results Wireless Smoke Alarm
1 ~ F	Same Channel	LED: Flashes immediate alarm
0	All CHANNEL	LED: Flashes, immediate alarm
1 ~ F	0	LED: Flashes 3 minutes before alarm

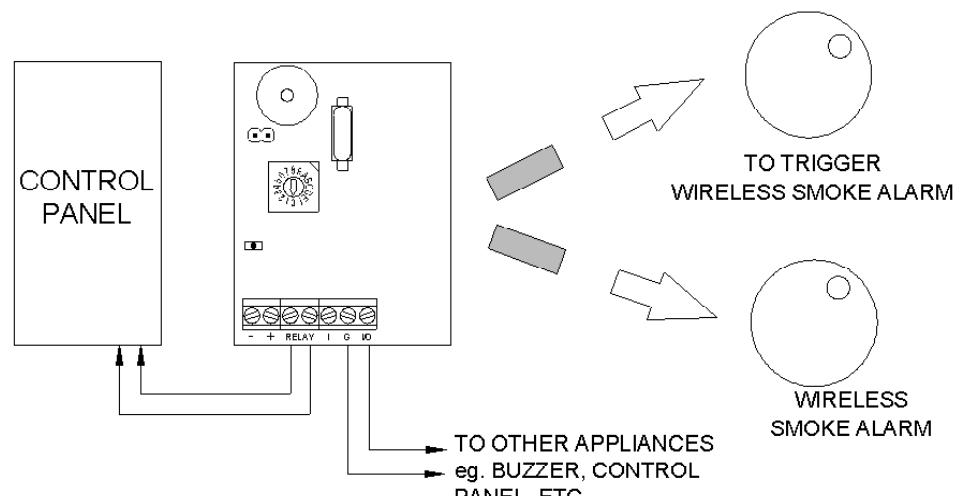

WARRANTY

The control unit is warranted to be free from defects in material and workmanship for one year from the date of purchases. This only applies if the control unit is correctly installed and used in the normal way and maintenance carried out regularly, Warranty void if abuse, or modified or attempted repairs is apparent.

The manufacturer will not guarantee on performance of the control unit /smoke alarm system for the following circumstances:

- 1) Installed network beyond specified receiving range.
- 2) Improper installation and setup.
- 3) Unexpected interference from other radio transmitting devices in the area.
- 4) Installed by unqualified personnel.

9VDC CONTROL UNIT MANUAL

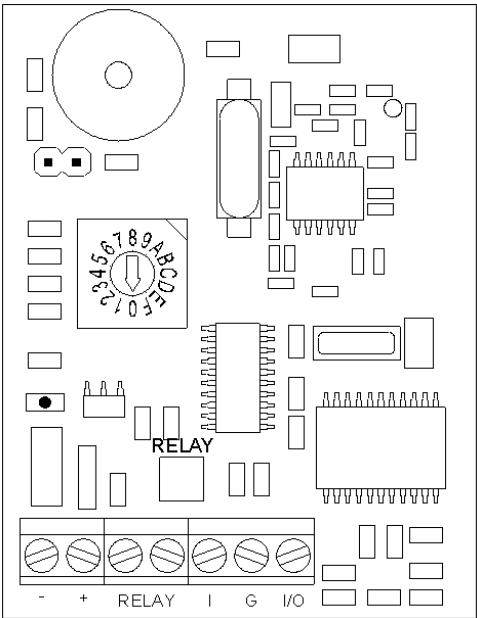

The control unit almost covers all kind of existing control panel and similar application such as emergency dialer, sirens, emergency lighting, call points, fire and / or police station, air exhausting system, emergency door locker released system etc. It can put together on attached or install just next to the panel with wiring. When the control unit receives the signal from our wireless system or control panel, it can transfer the signal to other alarms and/or application with or without delay time.

Relay output: Immediately with NO, COM, 30Ω contacts/350V, 120mA
Frequency Range: 434.33 MHz
Approval: R&TTE

Regular check the range and function, please note that the radio condition and interference can change over time, no guarantee given to a specific transmission range

Low Battery Warnings
If power supply drop below 7.0V it will start beeping once per every 8 seconds.

INTRODUCTION

PR1211 wireless smoke alarm can easily communicate with CM02 control unit, which can provide signal to link with common residential or industrial fire alarm control panel.

Warning: test after installation by authorized & qualified technical personnel to ensure proper installation and setup.

For the sake of customer safety protection, weekly test is required and recommended, as per the instruction manual.

INSTALLATION

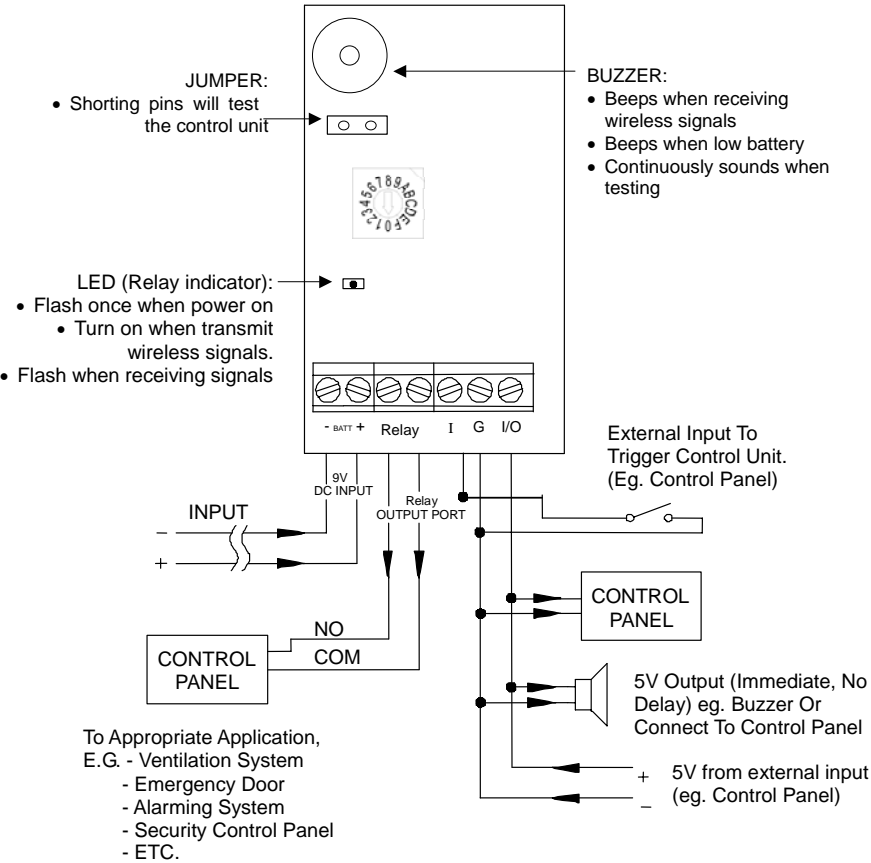

TESTING OF TERMINAL & TRANSMISSION FUNCTION

Properly Install Control Unit Before Testing

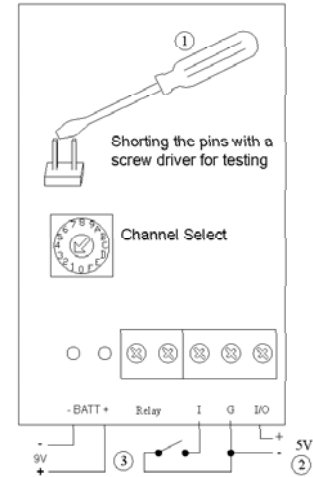

- Short the "jumper" with screwdriver until, LED flashes 4 times. LED will illuminate and then release test jumper. The wireless signal will continue to transmit for about one minute.
- For any channel, if connect a 5V across IN/OUT (+) & GND (-) port at the terminal block, the wireless signal will be transmitted as long as 5V input is applied
LED: FLASH
- Directly wiring "in" port to GND. at the terminal, the wireless signal will be transmitted as long as the status continues.
LED: FLASH

For testing control as receiver, refer to the following table to see if it is according to your application requirement

CONTROL UNIT AS A RECEIVER

Smoke Alarm System – with or without delay time

Wireless Smoke Alarm Channel	Control Unit Channel	Control Unit Results			
		LED	Relay	I/O Port	Sound
1 ~ F	Same Channel	Flash	Immediate	Immediate	Beep
0	All Channel	Flash	Immediate	Immediate	Beep
1 ~ F	0	Flash	3 Minute Delay	Immediate	Beep

