



setting up your wireless system

P300W, C300W, D300W and wireless interface



Standards
NFS 61 936
NFS 32001
EN 54-11



☎ 0330 999 2233
➤ www.firedepot.co.uk
✉ sales@firedepot.co.uk

Megalarm wireless system

General points

The Megalarm wireless fire alarm system is designed for small offices, shops, workshops, site cabins and temporary buildings. It can combine up to 10 units consisting of 1 master unit and 9 slave units, either manual call points or smoke detectors. The system is powered by batteries and requires no mains voltage supply.

The master P300W can be combined with either 9 more P300Ws, C300W radio manual call points (MCP), radio smoke heads D300W or a combination of all 3 totalling no more than 9, plus the master. The instructions in this manual will enable you to commission all devices together, which when activated will register an alarm sound from all P300W units and D300W detectors.

Instructions for decommissioning can be found on the last page should you encounter any difficulties. This is important should you encounter any set up issue, decommission and start the configuration process again.

Technical Data

P300W master unit

Power Lithium 3V battery capacity: 1300mAh, IEC standard: CR17345 for the radio module & 6LR 61 Alkaline 9 volts battery for sounder/beacon operation autonomy: 5 years with at least 5 minutes alarm

Installation Method Surface mounted

Sounder Integral 90db within 2 meters

Strobe Lights Integral high power LEDs

Dimensions 126(W)x242(H)x75(D)mm

Colour White ABS

Manual Call Point Integral/wireless complete with 3V lithium battery

Wireless Range 100m in open area conditions, 30-40m if being used inside a building

C300W manual call point

Power Integral lithium 3V battery, capacity: 1400mAh, IEC standard: CR17345

Range Maximum range between manual call point and base = 100m in open area conditions

Installation Mounting Surface mounted

Resetting Key Included

Wireless Range 100m in open area conditions, 30-40m if being used inside a building

D300W wireless smoke detector

Power Lithium sealed in battery (non-replaceable)

Sounder Integral 85db

Test Button Integral

Operating Temperature 0 °C - 55 °C

Radio Linking Frequency 868 Mhz

Wireless Range 100m in open area conditions, 30-40m if being used inside a building

Wireless interface (optional - not a stock item)

Power 12V via fire alarm panel

Operating Temperature 0 °C - 55 °C

Dimensions 83(W)x83(H)x46(D)mm

Interconnection Capacity Smoke detectors unlimited

Wireless Range 100m in open area conditions, 30-40m if being used inside a building

setting up your wireless system

The Megalarm wireless fire alarm system is designed for small offices, shops, workshops, site cabins and temporary buildings. It can combine up to 10 units consisting of 1 master unit and 9 slave units, either manual call points or smoke detectors. The system is powered by batteries and requires no mains voltage supply.

step 1 your P300W unit (One of these is also used as the master unit)

Commissioning your system requires that you make a P300W unit the master and all other components slaves. (Further P300W units and /or both C300W or D300W)

stage one, opening and closing your master P300W unit

Open your P300W unit using the black key supplied. Using the 2 pins of the key press in the 2 slots on the underside of the unit. To close the unit simply click the lid back into place and return key to the holding slot on top of the unit

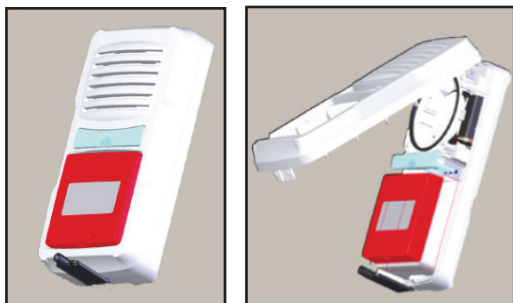

stage two, mounting your P300W to the wall

Fix the box at maximum 1.30 metres high using the integrated spirit level. Dimensions can be found on the drawing below

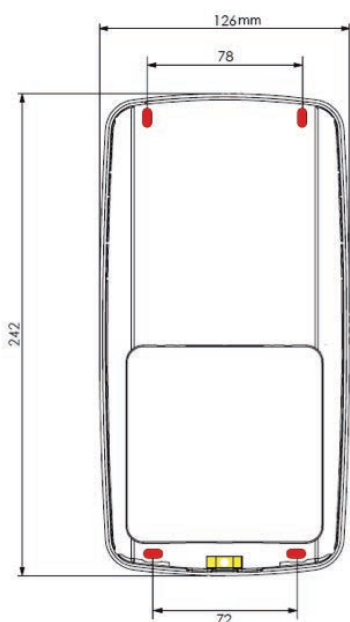

stage three, activating the batteries

Caution: Please ensure the batteries are correctly installed, observe the correct polarity as the PCB may be damaged if this is not carried out.

1. Connect the 9 volts 6 LR 61 Alcaline battery to the corresponding terminals in the box, on the right of the loudspeaker.
2. Remove the paper insulater from the lithium 3Vcc battery located inside the callpoint (MCP). (Refer to Step 2, stage one on how to access the MCP).

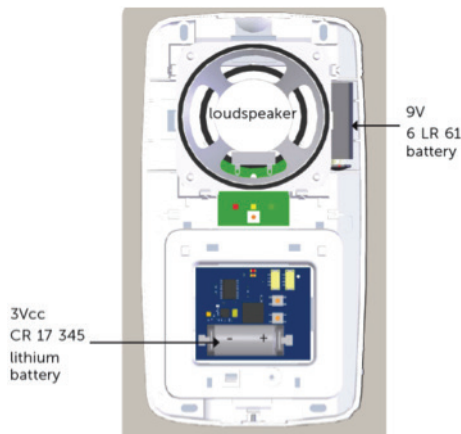

step ② Your C300W unit

stage one, opening your C300W unit

Simply unscrew the holding screw in the front of the box, then lift off the front face.

stage two, mounting your C300W

Fix the box at maximum 1.30 metres high.

Dimensions can be found on the drawing below

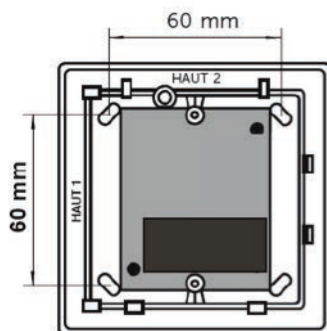

Note: Avoid placing the units on or near metal objects, electrical equipment or cabling.

Note: Do not install the unit nearer than 1 metre to electrical switchboard or cabling, metal objects or radio disturbance sources.

stage three, activating the batteries

Caution: Please ensure the batteries are correctly installed, observe the correct polarity as the PCB may be damaged if this is not carried out.

Remove the paper insulator from the lithium 3Vcc battery.

Configuring your Megalarm wireless system

First mark one of your P300W units as your master unit (label or write 'Master' on the back)

To Cancel the connection with a smoke detector or a stand alone alarm during the set up process

While in step 2 anywhere between points 3 and 8 and you encounter a problem or are not sure that you pressed the right button, press the configuration button for 10 seconds until you hear 4 long beeps which confirms that any connections have been cancelled.

1. Open the master unit and the first slave unit.
(Slave unit is either another P300W, C300W or D300W)
2. Place the slave next to the master unit.
3. Press the CONFIG button in the slave unit for 5 seconds, the unit will beep to indicate each second, and then release.
This does not apply to the D300W - see Step 3.
4. Once the unit has sent the configuration signal the buzzer will pulse and the amber LED will illuminate.
The slave now sends a request to be combined with the master.
This is indicated by 1 beep every 3 seconds
5. Press the VALID button in the master until you hear a long beep and then release.
6. The slave is now linked to the master unit and will now enter the 'signal strength' mode.
7. Take the slave to the preferred location and ensure the signal strength is adequate, the unit will beep indicating the signal strength. You should try to achieve at least a signal strength of 3

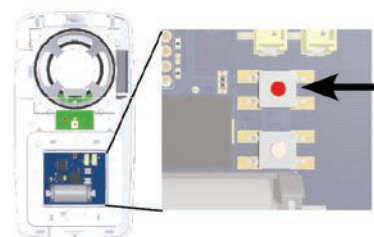
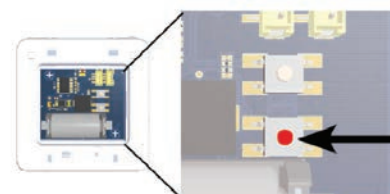
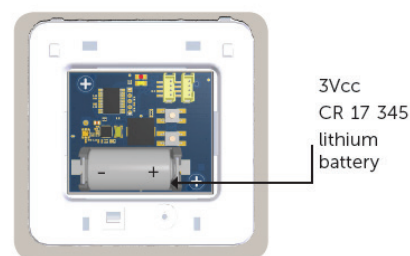

Number of Beeps	1	2	3	4	5
Signal Strength	Very weak	Weak	Medium	Good	Very good

8. Once positioned in its final setting press and release the VALID key on the slave it will beep 3 times very quickly to enter normal service.

9. The master will also beep 4 times as it enters normal service. The system is now operational.

Note: to add further C300W or stand alone P300W units (as a slave to the master) repeat previous steps 1 to 9.

Note: maximum extra components as slaves is 9 .

step ③ adding a D300W radio smoke detector

Note: Do one configuration at a time

1. To link the smoke detector to the master, open the master P300W box.
2. Place the D300W unit you wish to link next to the master unit and remove the battery isolation tag from the underside of the smoke detector. Put the key away in the location space provided (see below on the right).

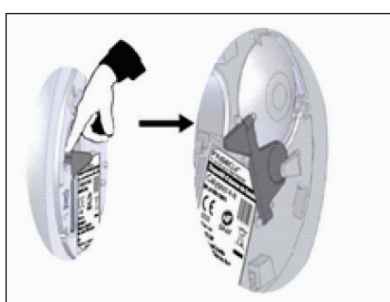

3. Within 20 seconds of removing the tag, press the clear button on the side of the D300Wsmoke detector and the unit will beep, release the button and the LED will flash Blue.
4. Press the VALID button in the master unit until you hear a long beep and release.
5. The smoke detector is now linked to the master unit and will now enter the 'signal strength' mode.
6. Take the detector to the required location for installation, the detector will regularly beep up to 5 times to indicate signal strength.

Number of Beeps	1	2	3	4	5
Signal Strength	Very weak	Weak	Medium	Good	Very good

7. If the signal strength is acceptable press the button on the side of the smoke detector and it is now paired with the master. The system is now operational.

Note: to add further smoke detectors repeat previous steps 1 to 6.

Maintenance notes

We advise you to keep the equipment clean and to ensure the installation is in a dry and ventilated area.

Checking that components are connected and their signal strength in Diagnostic Mode

To activate the diagnostic mode, press the transparent lens between the sounder and the callpoint on the master unit for 5 seconds.

The diagnostic mode is activated when the green LED of the master unit blinks.

Each connected unit beeps, the beeps correspond to the quality of the signal strength.

To end the diagnostic mode just press the transparent lens once.

Faults

Master unit Faults

A fault is identified by a flashing orange light on the master unit and a number of beeps on the master and/or the MCP.

Number of beeps	Faulty Unit	Fault	Explanation
1	Master	Battery	The master unit battery is faulty
2	Master MCP	Battery	The master unit MCP battery is faulty
3	MCP	Battery	An MCP has a faulty battery
4	MCP	Communication	An MCP has a communication fault

Manual call point (MCP) faults

Number of beeps	Faulty Unit	Fault	Explanation
1	MCP	Battery	The manual call point battery is faulty
2	MCP	Communication	No signal has been recieved from the

Battery Fault

Replace the defective Lithium 3Vcc CR 17 345 for the MCP including the One installed in the master unit.

Replace the 9V 6 LR 61 battery inside the master unit.

Communication Fault

Go in to the diagnostic mode described earlier to check the quality and strength of the signal, relocate if required or investigate if there is a new obstruction or interference causing the fault.

Clearing Configuration / Decommissioning

If at any point you are unsure of the number of MCP’s paired with the system, or are having problems commissioning, or wish to relocate the wireless system or reduce the number of paired units, then you will **need to decommission the slaves one at a time**. Both the Master P300W and D300W can not be decommissioned, however, the D300W can be moved and re-commissioned, using the normal procedur eas set out in the step 3 to a different master

To decommission a slave P300W or a C300W, you will need to:

Press and hold the CONFIG button and the VALID button together until you here 3 short beeps, 4 long beeps and then 1 short beep and then release the buttons, the C300W is now decommissioned from the system and can be added back using the normal procedure as set out in step 2.



☎ 0330 999 2233
 🖱 www.firedepot.co.uk
 ✉ sales@firedepot.co.uk