

Power Selectable EN2~4 } (BS EN1154:1997)

Choix de pose du Ferme porte: Force 2 / 3 ou 4

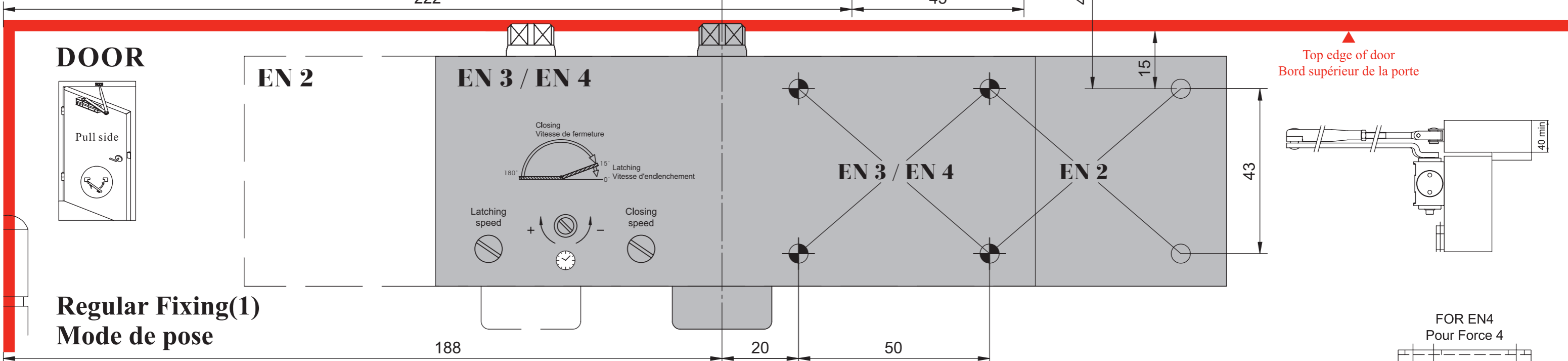

Power size	Max. Door width	Max. Door weight	Max. Door opening
EN2	850mm	40Kg	180°
EN3	950mm	60Kg	180°
EN4	1100mm	80Kg	130°
4	1100mm	80Kg	180°

Ø drilling	Ø de perçage
Ø2,5	Ø4,2
for wood door pour porte bois	for metal door pour porte métallique

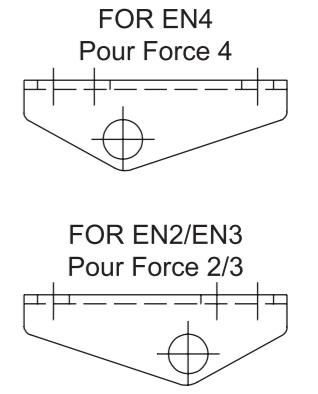
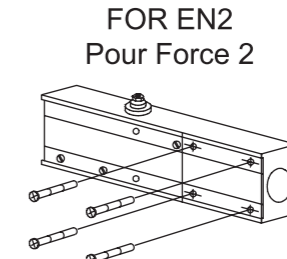
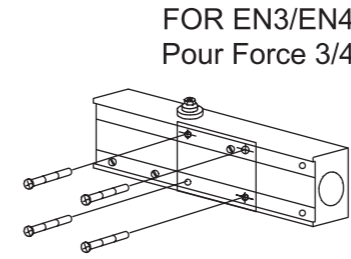

Fold Here

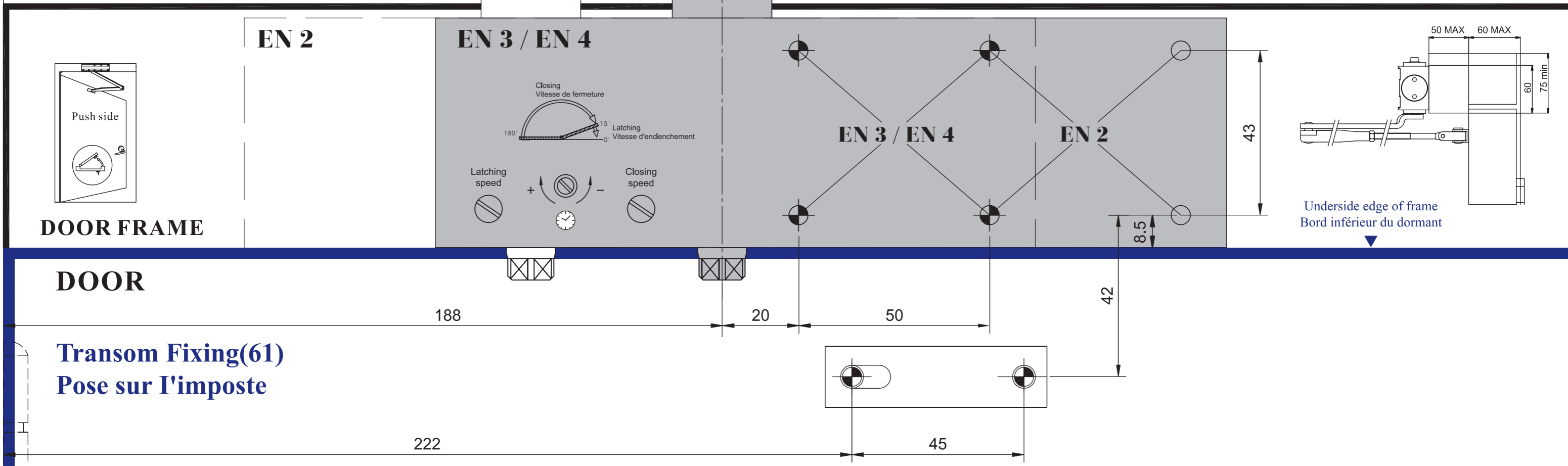

Power Selectable EN2~4 } (BS EN1154:1997)
 Choix de pose du Ferme porte: Force 2 / 3 ou 4

Top edge of door
 Bord supérieur de la porte

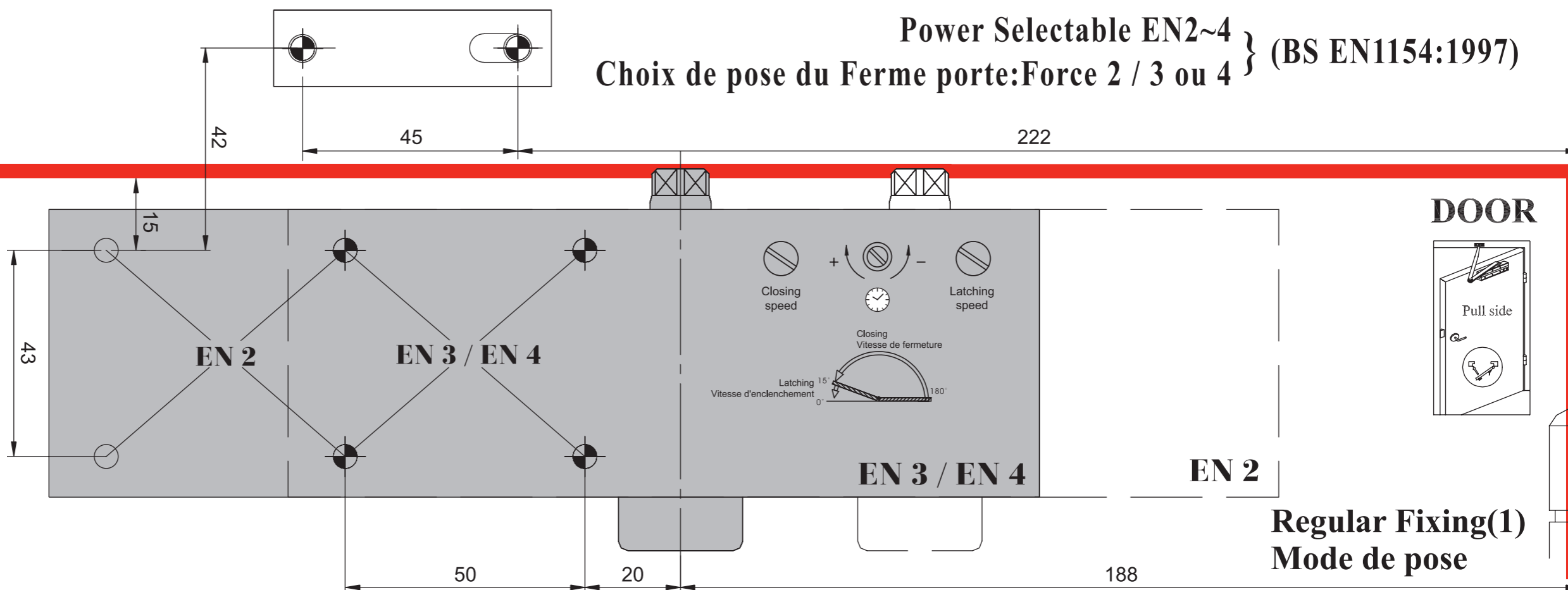
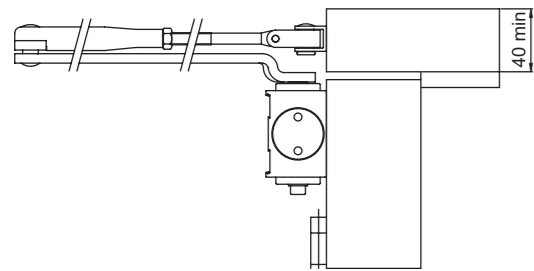

DOOR

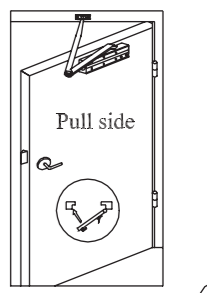

Regular Fixing(1)
 Mode de pose

FOR EN4
 Pour Force 4

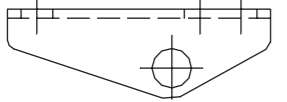

FOR EN2/EN3
 Pour Force 2/3

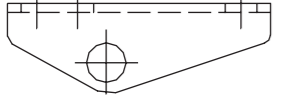

FOR EN2
 Pour Force 2

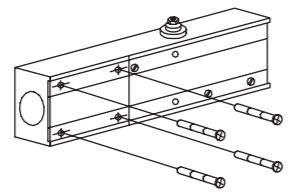

FOR EN3/EN4
 Pour Force 3/4

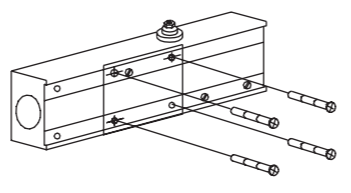

Ø drilling	Ø de perçage
Ø 2,5	Ø 4,2
for wood door pour porte bois	for metal door pour porte métallique

Power size	Max. Door width	Max. Door weight	Max. Door opening
EN2	850mm	40Kg	180°
EN3	950mm	60Kg	180°
EN4	1100mm	80Kg	130°
4	1100mm	80Kg	180°

Fold Here

Underside edge of frame
 Bord inférieur du dormant

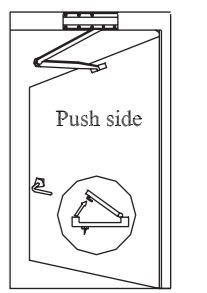
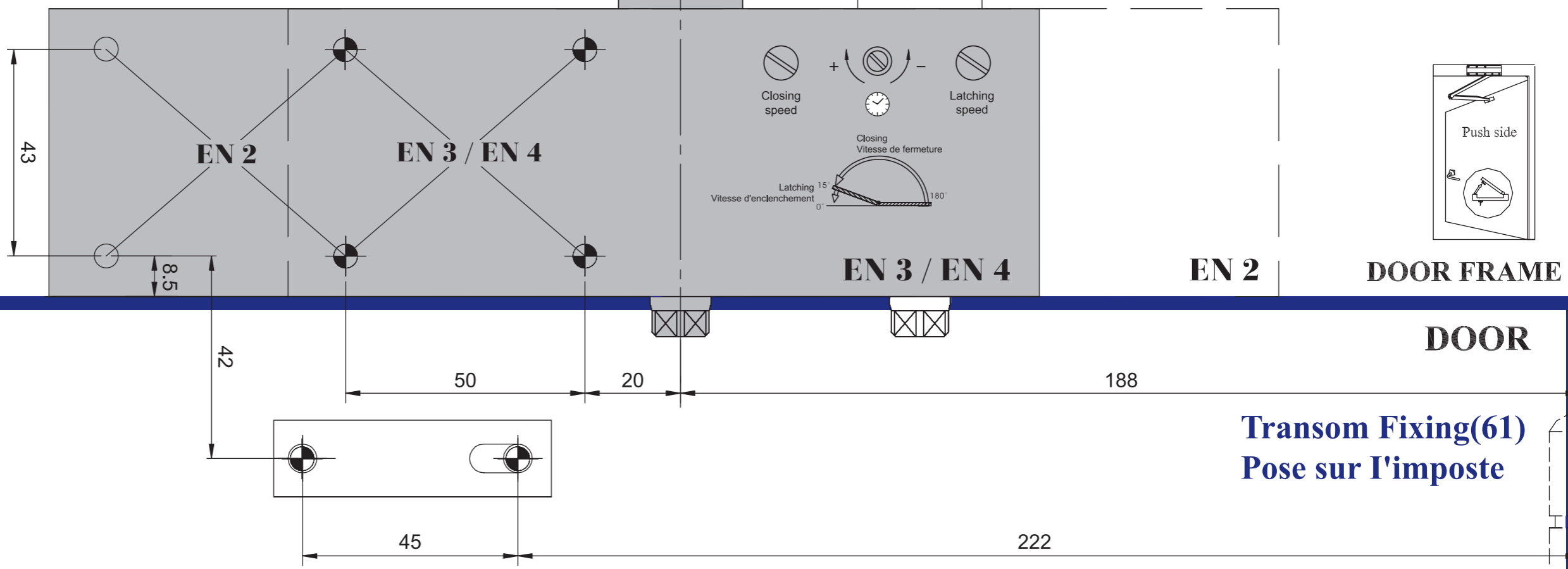
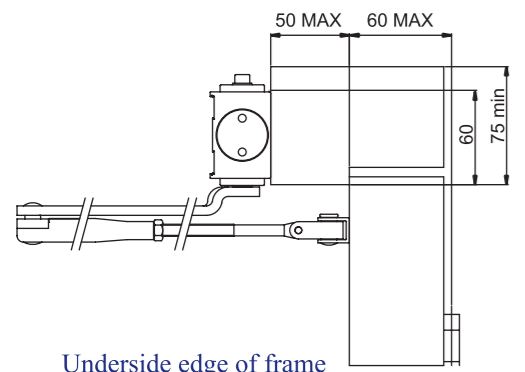

DOOR FRAME

DOOR

Transom Fixing(61)
 Pose sur l'imposte