

BOX

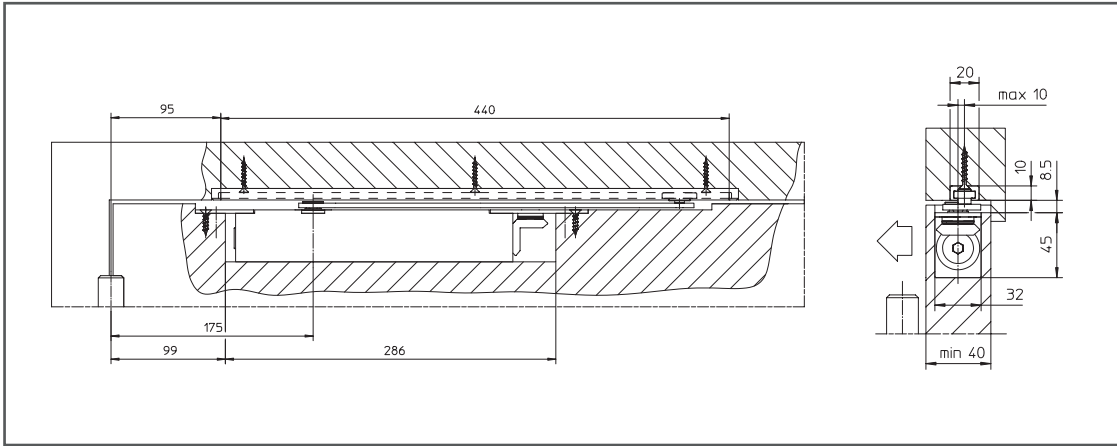

GEZE Boxer size 2-4 with Boxer guide rail

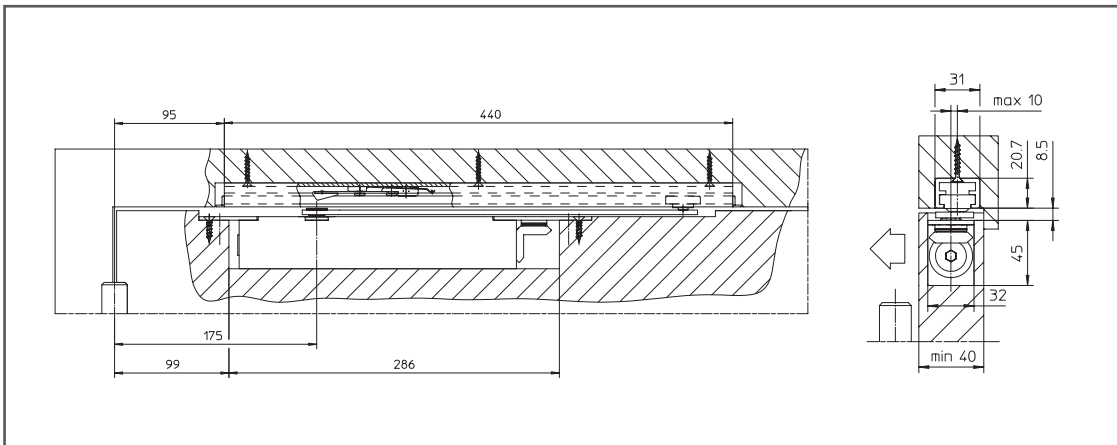

GEZE Boxer size 2-4 with Boxer guide rail with mechanical hold-open device

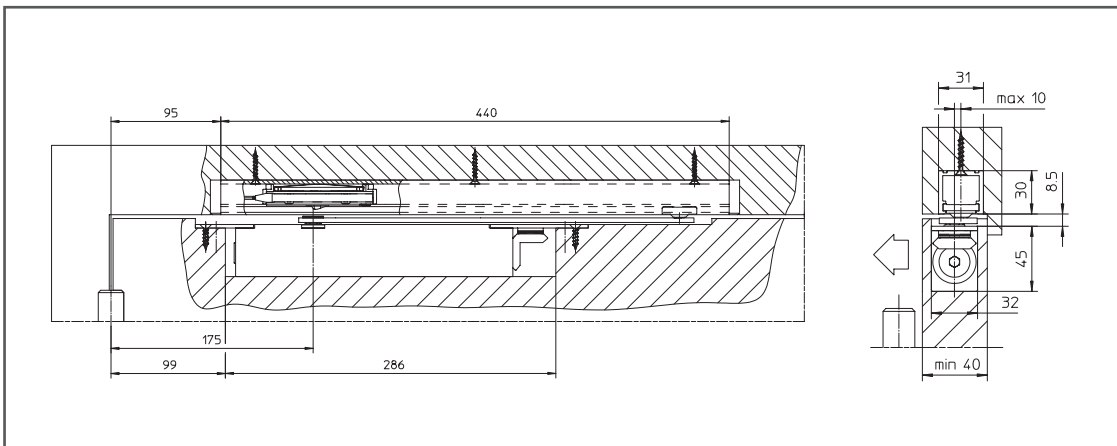

GEZE Boxer size 2-4 with Boxer E-guide rail

GEZE *Boxer Gr. 2 - 4*

Gr. 3 - 6

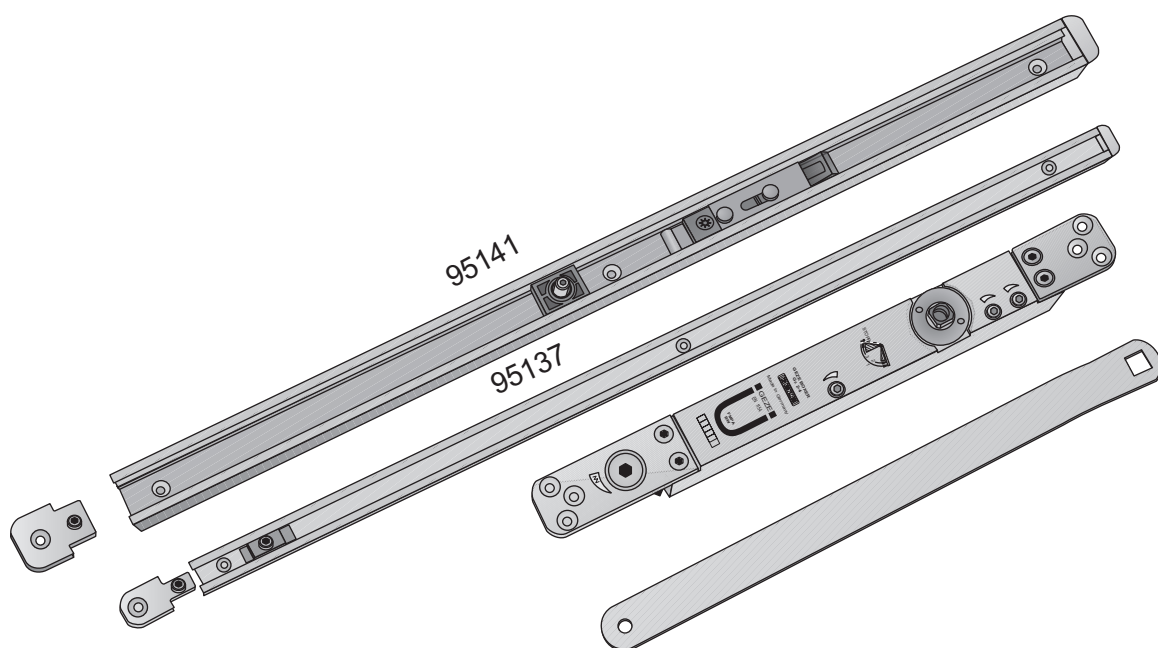

(D) *Türschließer*
Montageanleitung

(GB) *Door Closer*
Installation instructions

(F) *Ferme-porte*
Instructions de montage

(I) *Chiudiporta*
Istruzioni di montaggio

(NL) *Deurdranger*
Montage handleiding

(S) *Dörrstängare*
Installation och driftsanvisningar

(PL) *Samozamykacz drzwiowy*
Instrukcja montażu

(D)	Abmessungen	Schließkraft	Gewicht
(GB)	Dimensions	Closing force EN size	Weight
(F)	Dimensions	Force de fermeture	Poids
(I)	Dimensioni	Forza secondo	Peso
(NL)	Afmetingen	Sluitkracht	Gewicht
(S)	Dimensioner	Stängningskraft	Vikt
(PL)	Wymiary	Siła zamykania	Ciężar
Gr. 2 - 4	271 x 42 x 32 mm	Gr. 2 - 4	1,4 kg
Gr. 3 - 6	276 x 51 x 40mm	Gr. 3 - 6	2,1 kg

- (D) Holztür und -Rahmen
- (GB) Wooden door and frame
- (F) Portes et cadres en bois
- (I) Porta e telaio in legno
- (NL) Houten deur en kozijn
- (S) Trädörr och -karm
- (PL) Drzwi i ościeżnice drewniane

- (D) Metalltür und -Rahmen
- (GB) Metal door and frame
- (F) Portes et cadres en métal
- (I) Porta e telaio in metallo
- (NL) Metalen deur en kozijn
- (S) Metalldörr och -karm
- (PL) Drzwi i ościeżnice metalowe

- (D) **Vormontage Gleitschiene**
- (GB) **Preset guide rail**
- (F) **Préassemblage de la coulisse**
- (I) **Preparazione braccio a slitta**

- (NL) **Voormontage glijrail**
- (S) **Förbereda glidskenan**
- (PL) **Montaż wstępny szyny ślizgowej**

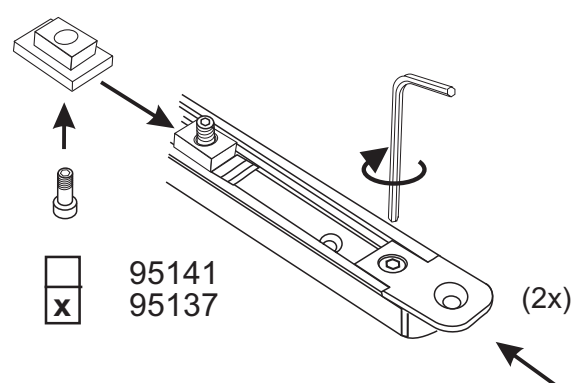
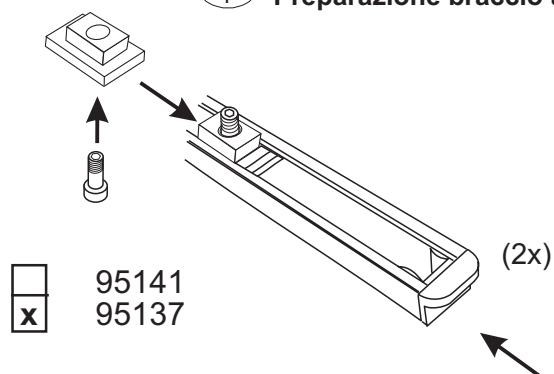

- (D) **Vormontage mechanische Feststellung**
- (GB) **Preset mechanical hold-open device**
- (F) **Préassemblage arrêt mécanique**
- (I) **Preparazione fermo meccanico**

- (NL) **Voormontage mechanische vastzetting**
- (S) **Förbereda mekanisk uppställning**
- (PL) **Montaż mechaniczną blokadą otwarcia skrzydła**

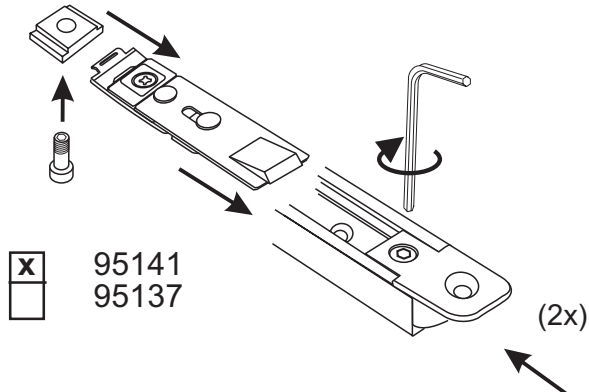
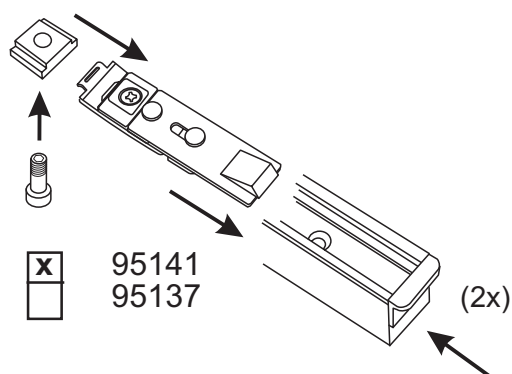

- (D) Einbaumaße Holztür
- (GB) Mounting dimensions wooden door
- (F) Cotes de montage porte en bois
- (I) Dimensioni montaggio porta in legno

- (NL) Inbouwmaten houten deur
- (S) Inbyggnadsmått trädörr
- (PL) Wymiary montażowe dla drzwi drewnianych

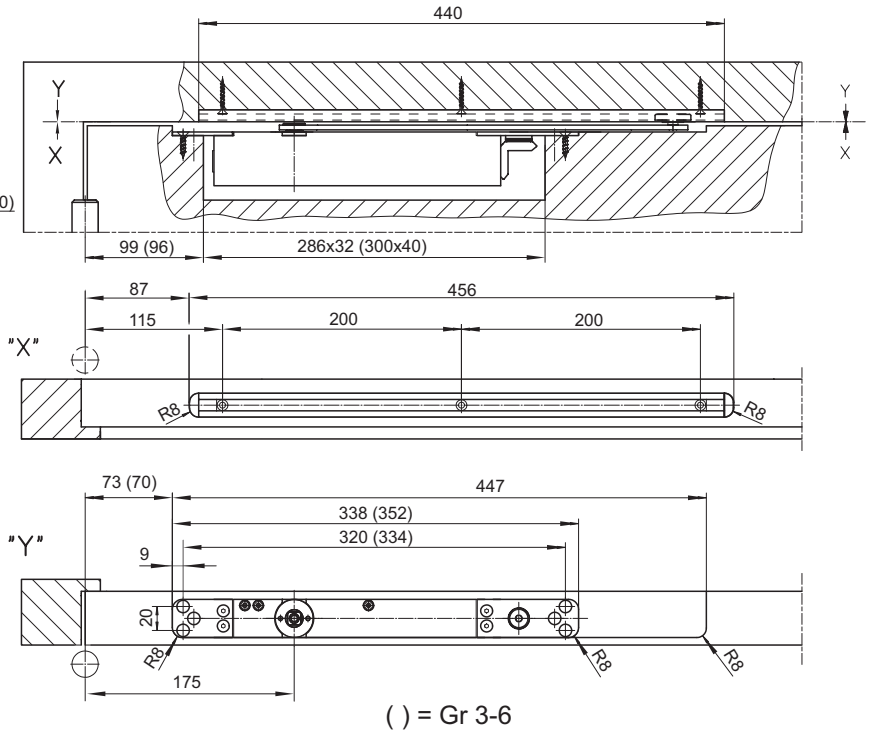
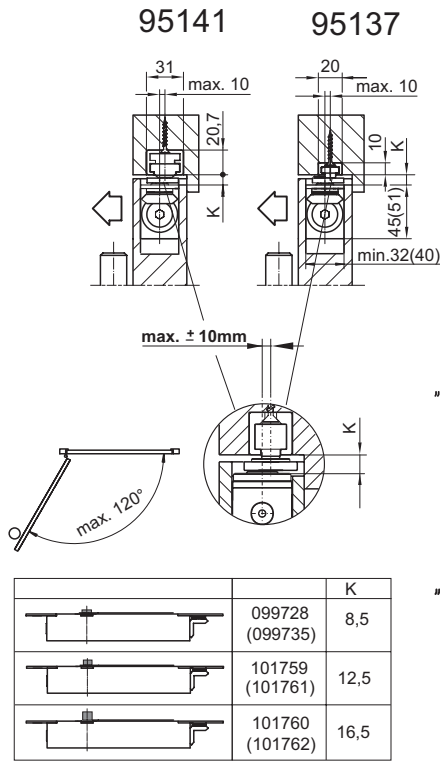

- (D) Einbaumaße Metallrahmen
- (GB) Mounting dimensions metal frame
- (F) Cotes de montage porte en métal
- (I) Dimensioni montaggio telaio in metallo

- (NL) Inbouwmaten metalen kozijn
- (S) Inbyggnadsmått metallkarm
- (PL) Wymiary montażowe dla ościeżnic metalowych

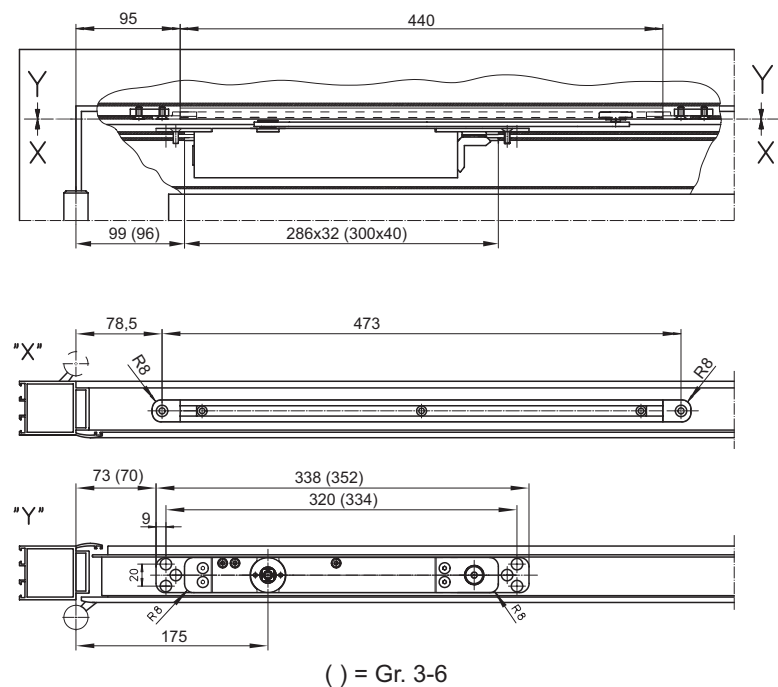
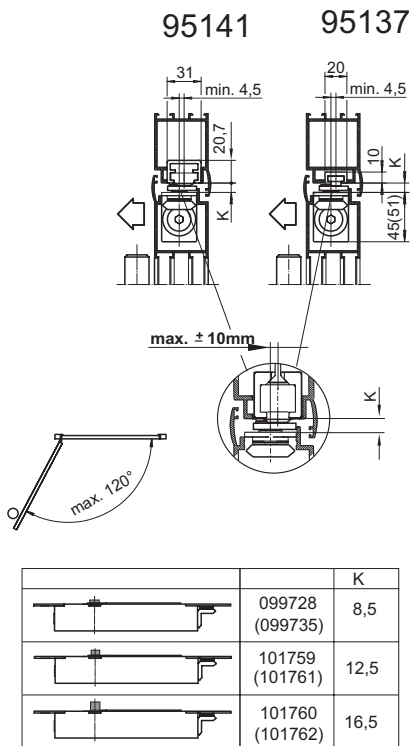

- (D) Vormontage
- (GB) Pre-assembly
- (F) Préassemblage
- (I) Premontaggio
- (NL) Voormontage
- (S) Förmontage
- (PL) Montaż wstępny

1

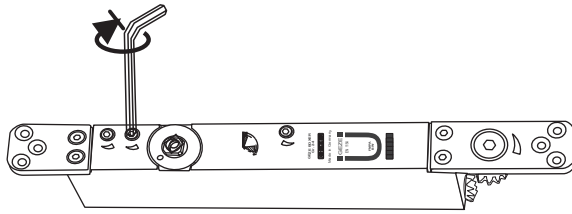

Schließzeit 'Zu'
 Closing time 'lock'
 Durée de fermeture à
 Tempo di chiusura 'chiuso'
 Sluittijd 'dicht'
 Stängningstid 'Stängd'
 Zwiększanie czasu
 zamykania

2

'L' = DIN -
 - links
 - left
 - gauche
 - sinistra
 - links
 - höger
 - drzwi lewe wg DIN

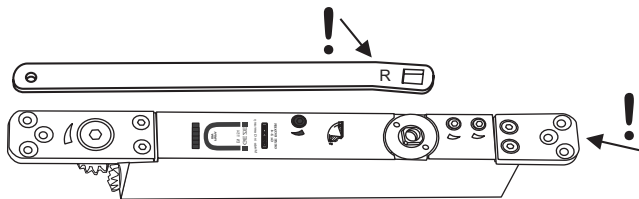
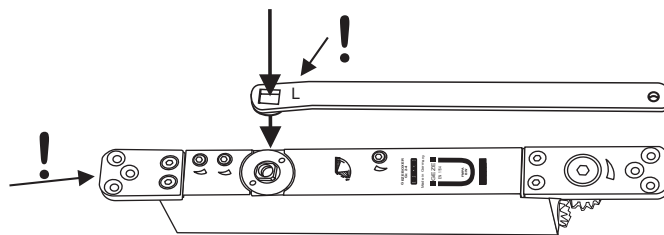

'R' = DIN -
 - rechts
 - right
 - droite
 - destra
 - rechts
 - höger
 - drzwi prawe wg DIN



3

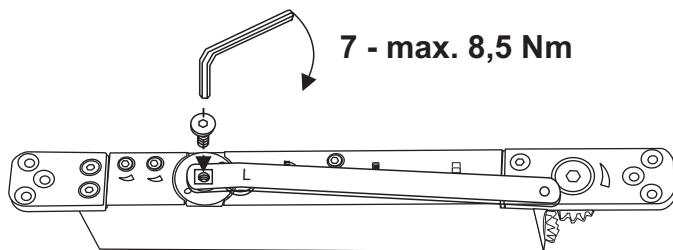

4

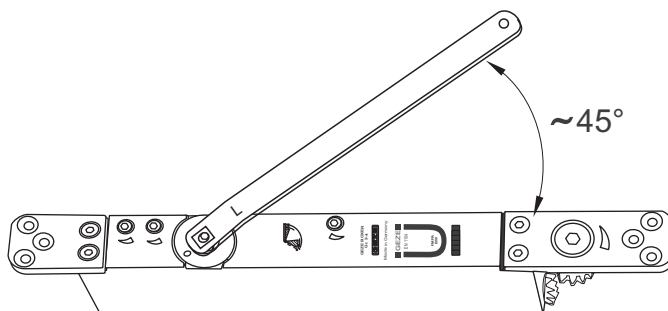

- Ⓓ Montage GEZE *Boxer* in das Türblatt
- ⒼⒸ Mounting of GEZE *Boxer* into the door leaf
- Ⓕ Montage GEZE *Boxer* dans le vantail
- Ⓘ Montaggio GEZE *Boxer* nel battente
- ⒶⒼ Montage GEZE *Boxer* in de deur
- ⒶⒶ Montage av GEZE *Boxer* i dörrbladet
- ⒶⒶ Montaż samozamykacza GEZE *Boxer* w skrzydle drzwiowym

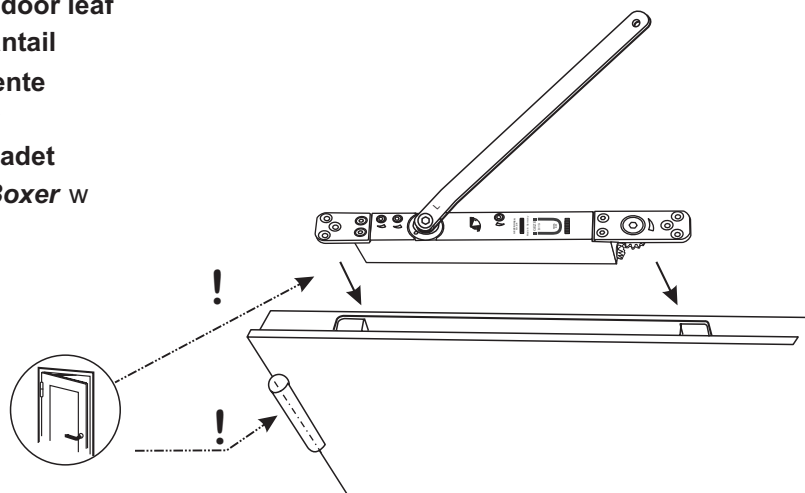

- Ⓓ Montage der Gleitschiene, Holztür
- ⒼⒸ Mounting of guide rail, wooden door
- Ⓕ Montage de la coulisse, porte en bois
- Ⓘ Mont. del braccio a slitta, porta in legno
- ⒶⒼ Montage van de glijrail, houten deur
- ⒶⒶ Montage av glidskenan, trädörr
- ⒶⒶ Montaż szyny ślizgowej – Drzwi drewniane

- Ⓓ Montage der Gleitschiene, Metalltür
- ⒼⒸ Mounting of guide rail, metal door
- Ⓕ Montage de la coulisse, porte en métal
- Ⓘ Mont. del braccio a slitta, porta in metallo
- ⒶⒼ Montage van de glijrail, metalen deur
- ⒶⒶ Montage av glidskenan, metalledörr
- ⒶⒶ Montaż szyny ślizgowej – Drzwi metalowe

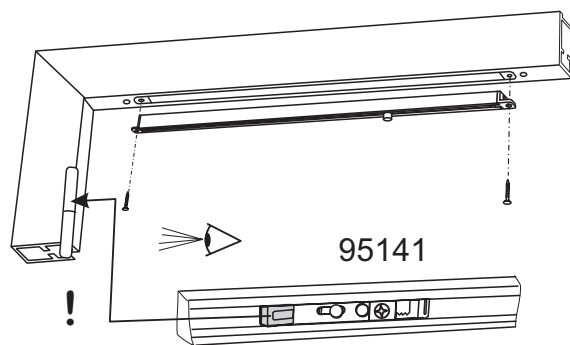
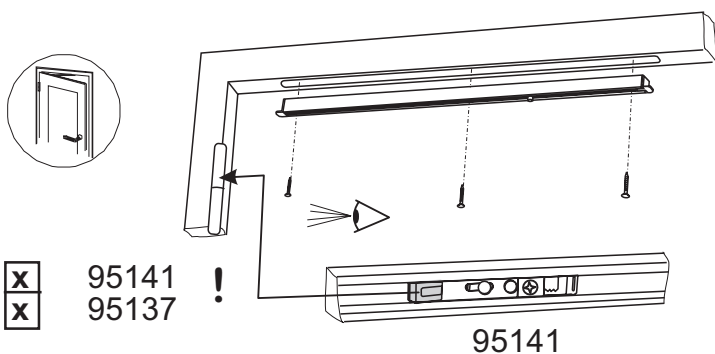

- Ⓓ Hebel mit Gleitschiene verschrauben
- ⒼⒸ Screwing lever and guide rail together
- Ⓕ Visser le levier avec la coulisse
- Ⓘ Avvitare leva con braccio a slitta
- ⒶⒼ Arm op glijrail vastschroeven
- ⒶⒶ Skruva fast armen på glidskenan
- ⒶⒶ Łączenie dźwigni z szyną ślizgową

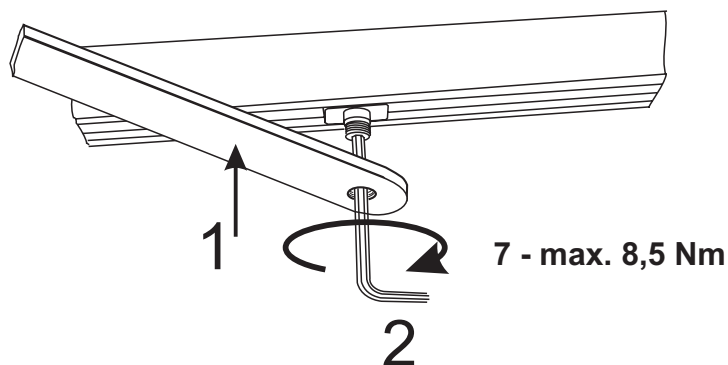

- X 95141
- X 95137

- Ⓓ **Einstellungen am GEZEBoxer**
- ⒼⒷ **Adjustment of GEZEBoxer**
- Ⓕ **Réglages sur le GEZEBoxer**
- Ⓘ **Regolazioni sul GEZEBoxer**
- ⒶⒻ **Instellingen op de GEZEBoxer**
- Ⓐ **Inställningar på GEZEBoxer**
- ⒶⒻ **Regulacje samozamykacza GEZE Boxer**

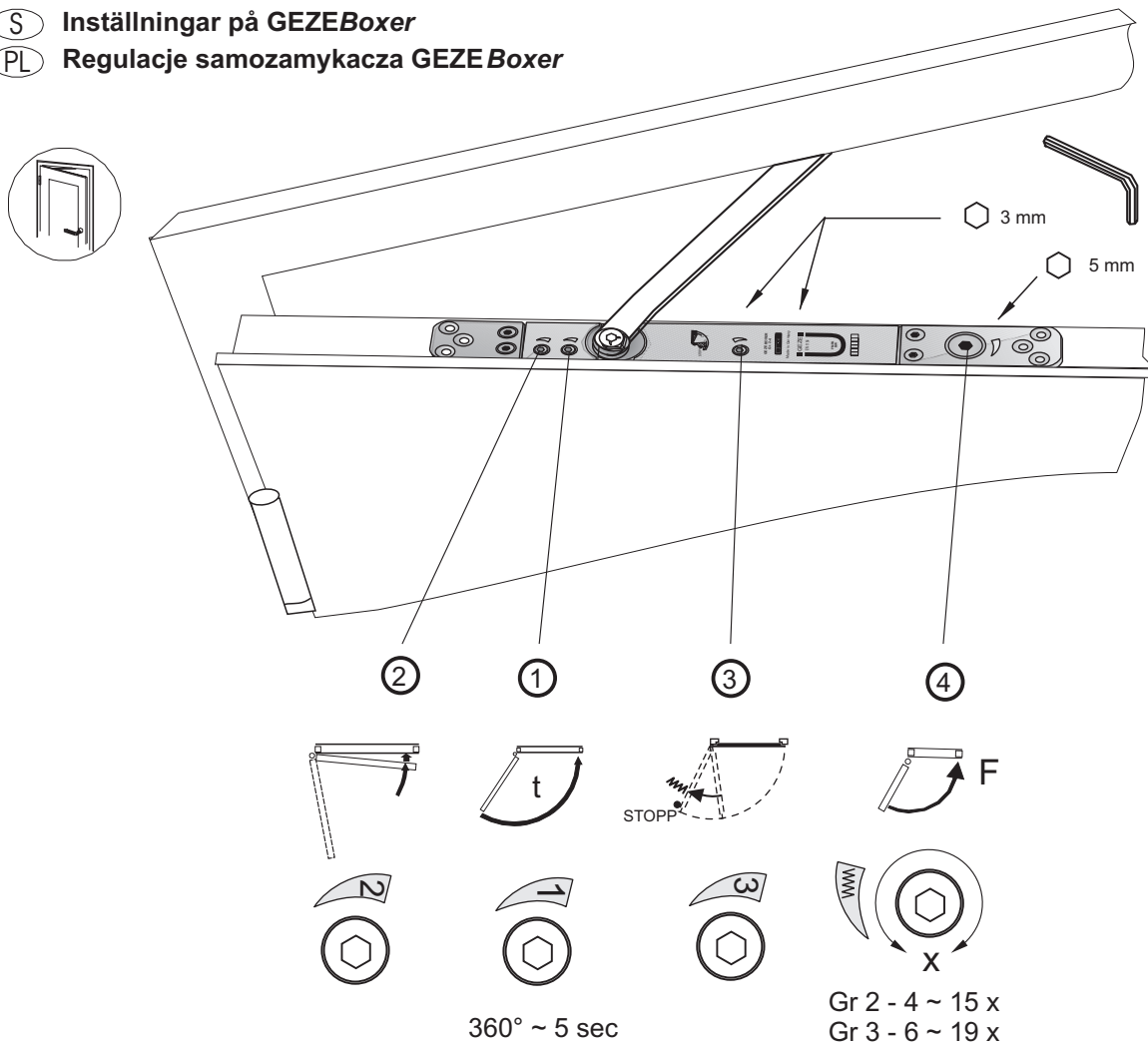

Ⓓ	Ⓘ	ⒼⒷ	Ⓕ
Ⓓ Schließkraft	Ⓘ Schließzeit	ⒼⒷ Closing force	Ⓕ Öffnungsdämpfung
Ⓕ Force de fermeture	Ⓕ Durée de fermeture	ⒼⒷ Back check	Ⓕ Amortissement d'ouverture
Ⓘ Forza di chiusura	Ⓘ Tempo di chiusura	Ⓕ À-coup final	Ⓘ Ammortizzatore di apertura
ⒶⒻ Sluitkracht	ⒶⒻ Sluittijd	ⒶⒻ Arresto finale	ⒶⒻ openingdemping
Ⓐ Stängningskraft	Ⓐ Stängningstid	ⒶⒻ Eindslag	ⒶⒻ öppningsbroms
ⒶⒻ Siła zamykania	ⒶⒻ Czas zamykania	ⒶⒻ Tillslagskraft	ⒶⒻ tłumienie otwierania
		ⒶⒻ Dobicie końcowe	

- ⓓ Einstellungen mech. Feststellung
- Ⓒ⒃ Adjustment of hold-open devise
- Ⓕ Réglares de l'arrêt mécanique
- Ⓛ Impostazioni del fermo meccanico

- Ⓒ⒗ Instellingen van de mechanische vastzetting
- Ⓕ Ställ in mekanisk uppställning
- Ⓒ⒗ Ustawienia mechaniczną blokadą otwarcia skrzydła

95141
 95137

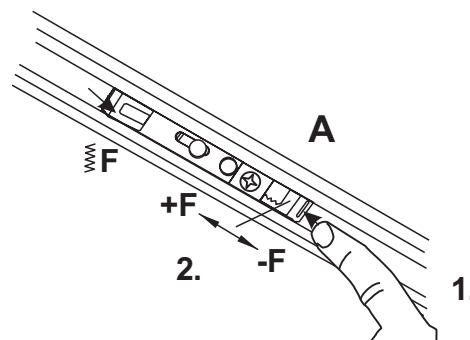
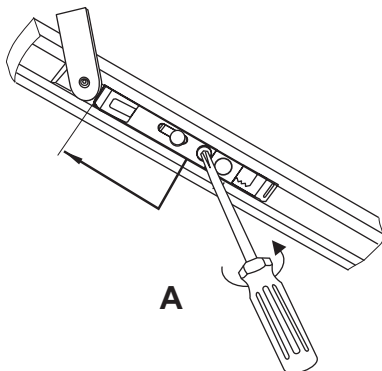
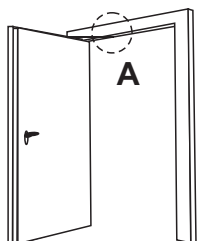

- ⓓ Stopper setzen (max. 120°)
- Ⓒ⒃ Setting of the opening limitation (max. 120°)
- Ⓕ Réglares de la limitation d'ouverture (max. 120°)
- Ⓛ Regolazioni della limitazione di apertura (max. 120°)
- Ⓒ⒗ Instellingen van de openingsbegrenzing (max. 120°)
- Ⓕ Inställningar av öppningsbegränsaren (max. 120°)
- Ⓒ⒗ Nastawianie ograniczania otwarcia (max. 120°)

95141
 95137

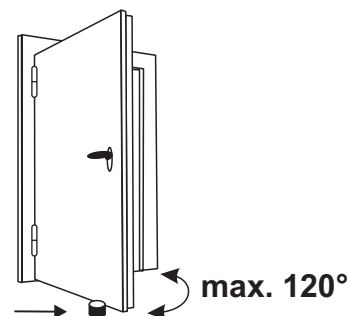

- | | |
|-----------------------|---|
| ⓓ Wartung | ⓓ Prüfung aller Befestigungsschrauben auf festen Sitz |
| Ⓒ⒃ Maintenance | Ⓒ⒃ Checking all fastening screws for close fit |
| Ⓕ Entretien | Ⓕ Contrôle de la bonne tenue de toutes les vis de fixation |
| Ⓛ Manutenzione | Ⓛ Controllo della tenuta di tutte le viti di fissaggio |
| Ⓒ⒗ Onderhoud | Ⓒ⒗ Controle op het goed vastzitten van alle bevestigingsschroeven |
| Ⓕ Underhåll | Ⓕ Kontrollera att alla fästsruvar är ordentligt fastskruvade |
| Ⓒ⒗ Konserwacja | Ⓒ⒗ Sprawdzanie prawidłowości dokręcenia śrub mocujących |

95141
 95137

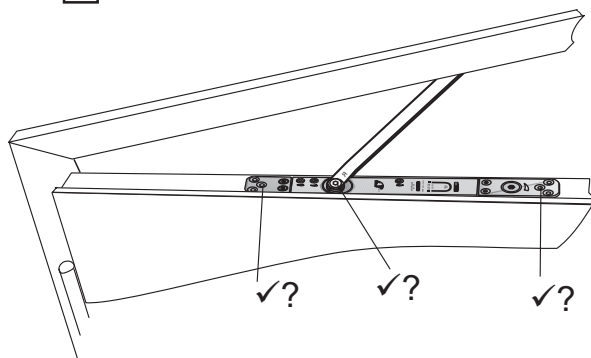

95141
 95137

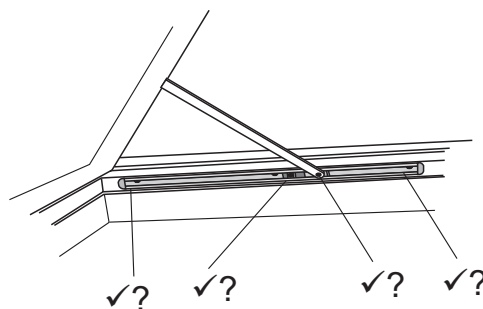

GEZE GmbH
P.O. Box 1363
71226 Leonberg
Germany

GEZE GmbH
Reinhold-Vöster-Str. 21-29
71229 Leonberg
Germany
Tel. +49 (0) 7152 - 203 - 0
Fax +49 (0) 7152 - 203 - 310

GEZE Online:
www.geze.com

GEZE Niederlassungen

Deutschland

GEZE GmbH

Niederlassung Nord/Ost
Bühningstr. 8
13086 Berlin (Weissensee)
Tel. +49 (0) 30 - 47 89 90 - 0
Fax +49 (0) 30 - 47 89 90 - 17
E-Mail: berlin.de@geze.com

GEZE GmbH

Niederlassung West
Nordsternstr. 65
45329 Essen
Tel. +49 (0) 201 - 8 30 82 - 0
Fax +49 (0) 201 - 8 30 82 - 20
E-Mail: essen@geze.com

GEZE GmbH

Niederlassung Mitte
Adenauerallee 2
61440 Oberursel (b. Frankfurt)
Tel. +49 (0) 6171 - 6 36 10 - 0
Fax +49 (0) 6171 - 6 36 10 - 1
E-Mail: frankfurt.de@geze.com

GEZE GmbH

Niederlassung Süd
Reinhold-Vöster-Straße 21-29
71229 Leonberg
Tel. +49 (0) 7152 - 203 - 5 94
Fax +49 (0) 7152 - 203 - 4 38
E-Mail: leonberg.de@geze.com

Tochtergesellschaften

Deutschland

GEZE Sonderkonstruktionen GmbH

Planken 1
97944 Boxberg-Schweigern
Tel. +49 (0) 79 30 - 92 94 - 0
Fax +49 (0) 79 30 - 92 94 - 10
E-Mail: sk.de@geze.com

GEZE GLAS DESIGN GmbH

Reinhold-Vöster-Str. 21-29
71229 Leonberg
Tel. +49 (0) 7152 - 2 03 - 410
Fax +49 (0) 7152 - 2 03 - 5 57
E-Mail: glas.design.de@geze.com

GEZE SERVICE GmbH

Reinhold-Vöster-Str. 25
71229 Leonberg
Tel. +49 (0) 7152- 92 33 - 0
Fax +49 (0) 7152- 92 33 - 60
E-Mail: service.de@geze.com

GEZE SERVICE GmbH

Niederlassung Berlin
Bühningstraße 8
13086 Berlin (Weissensee)
Tel. +49 (0) 30 - 47 02 17 30
Fax +49 (0) 30 - 47 02 17 33

Asien

GEZE Asia Pacific Ltd.

Unit 2614, 26/F., Miramar Tower
1 Kimberley Road
Tsimshatsui, Kowloon
Hong Kong
Tel. +852 - 23 75 73 82
Fax +852 - 23 75 79 36
E-Mail: geze@netvigator.com

GEZE Industries (Tianjin) Co., Ltd.

Shuangchenzhong Road
Beichen Economic Development Area (BEDA)
Tianjin 300400, P.R. China
Tel. +86 22 26 97 39 95-0
Fax +86 22 26 97 27 02
E-Mail: geze@public1.tpt.tj.cn

GEZE Industries (Tianjin) Co., Ltd.

Branch Office Shanghai
Room No. 2303
Nan Zheng Building
580 Nanjing Road West
200041 Shanghai
P.R. China
Tel. +86 21 52 34 09-60
Tel. +86 21 52 34 09-61
Tel. +86 21 52 34 09-62
Fax +86 21 52 34 09-63
E-Mail: geze@public2.sta.net.cn

GEZE Industries (Tianjin) Co., Ltd.

Branch Office Guangzhou
Room 1213 Jie Tai Plaza
218-222 Zhong Shan Liu Road
510180 Guangzhou
P.R. China
Tel. +86 20 81 32 07 02
Tel. +86 20 81 32 07 03
Fax +86 20 81 32 07 05
E-Mail: geze-gz@163.net

GEZE Industries (Tianjin) Co., Ltd.

Branch Office Beijing
Room 606 Beijing East Ocean Centre
No.24A Jian Guo Men Wai Street
Chao Yang District
100022 Beijing
P.R. China
Tel. +86 10 65 15 58 29
Tel. +86 10 65 15 58 30
Fax +86 10 65 15 58 31
E-Mail: leigeze@dhms.eocean.cn.net

Mittlerer Osten

Jordanien

GEZE Middle East

P.O. Box 941 771
Shmeisani 11194
Wadi Saqra Street
Al Wifaq Center
Amman-Jordan
Tel. +962 6 55 38 99 7
Fax +962 6 55 38 93 0
E-Mail: geze@go.com.jo

Europa

Frankreich

GEZE France S.A.R.L.

ZAC de l'Orme Rond
RN 19
77170 Servon
Tel. +33 1 60 62 60 70
Fax +33 1 60 62 60 71
E-Mail: france.fr@geze.com

Großbritannien

GEZE UK Ltd.

Chelmsford Business Park
Colchester Road
Chelmsford, Essex CM2 5LA
Tel. +44 (0) 12 45 45 10 93
Fax +44 (0) 12 45 45 11 08
E-Mail: geze.uk@geze.com

GEZE Automatic Division

Claymore, Tame Valley Industrial Estate,
Tamworth, Staffordshire B77 5DQ
United Kingdom
Tel. +44 (0) 18 27 28 62 22
Fax +44 (0) 18 27 28 64 44
E-Mail: automatics.uk@geze.com

Italien

GEZE Italia Srl

Via Caduti di Sabbiano, 2
40011 Anzola Emilia (BO)
Tel. +39 051 -6 50 18 11
Fax +39 051 -6 50 18 33
E-Mail: italia.it@geze.com

GEZE Engeneering Srl

Via Borromeo, 4
200 17 Rho (Milano)
Tel. +39 02 93 90 95 59
Fax +39 02 93 90 93 32

Niederlande

GEZE Benelux B.V.

Industrieterrein, Kapelbeemd,
Leemkuil 1,
NL-5626 EA Eindhoven
Tel. +31(0) 40-2 62 90 80
Fax +31(0) 40-2 62 90 85
E-Mail: benelux.nl@geze.com

Österreich

GEZE Austria GmbH

Mayrwiesstraße 12
5300 Hallwang b. Salzburg
Tel. +43 - 662 66 31 42
Fax +43 - 662 66 31 42-15
E-Mail: austria.at@geze.com

Polen

GEZE Polska Sp.z o.o.

ul. 3-go Maja 101/103
05-080 Mszczeska gm. Izabelin
Tel. +48 (0) 22 752 29 00
Fax +48 (0) 22 752 29 01
E-Mail: geze@geze.pl

Schweiz

GEZE Schweiz AG

Bodenackerstr. 79
4657 Dulliken
Tel. +41 (0) 62 - 285 54 00
Fax +41 (0) 62 - 285 54 01
E-Mail: schweiz.ch@geze.com

Spanien

GEZE Iberia S.R.L.

C/Diputacion 188, D.128
08011 Barcelona
España
Tel. +34 9 02 19 40 36
Fax +34 9 34 51 59 60
E-Mail: iberia.es@geze.com

Skandinavien

Schweden

GEZE Scandinavia AB

Mallslingan 10
Box 7060
18711 Täby
Tel. +46 (0) 8 - 732 34 - 00
Fax +46 (0) 8 - 732 34 - 99
E-Mail: sverige.se@geze.com

Norwegen

GEZE Scandinavia AB avd. Norge

Postboks 63
2081 Eidsvoll
Tel. +47 (0) 639 571 70
Fax +47 (0) 639 571 73
E-Mail: norge.se@geze.com

Finnland

GEZE Finland

branch office of GEZE Scandinavia AB
Postbox 20
158 71 Hollola
Tel. +385 (0) 10-400 5100
Fax +385 (0) 10-400 5120

Gemäß der im "Produkthaftungsgesetz" definierten Haftung des Herstellers für seine Produkte sind die in dieser Broschüre enthaltenen Informationen (Produktinformationen und bestimmungsgemäße Verwendung, Fehlgebrauch, Produktleistung, Produktwartung, Informations- und Instruktionspflichten) zu beachten. Die Nichtbeachtung entbindet den Hersteller von seiner Haftungspflicht.

GEZE Repräsentant:

